

TDK | 东京电子 RSEL-2003W PDF



深圳创唯电子有限公司

<http://www.tdk-dz.com>

深圳市创唯电子有限公司

电话：400-900-3095 0755-21000796

手机：13006692189

企业QQ：800152669

公司官网：<http://www.szcwdz.com>

0.5A to 6A, 250VAC EMI Filters

Features

- ◆ Low Cost (Than RSAL Series)
- ◆ Lug or Wire Terminations
- ◆ Low Earth Leakage Current Option
- ◆ Conforms to UL, CSA and EN Safety Agency Certifications

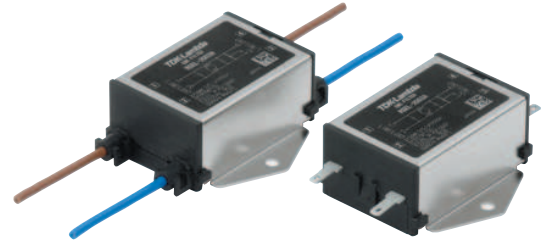

Specifications

| Model | RSEL-20R5W | | RSEL-2001W | | RSEL-2002W | | RSEL-2003W | | RSEL-2006W | |
|------------------------------|---|-------------|------------|-------------|------------|-------------|------------|-------------|------------|-------------|
| | RSEL-20R5A | RSEL-20R5WL | RSEL-2001A | RSEL-2001WL | RSEL-2002A | RSEL-2002WL | RSEL-2003A | RSEL-2003WL | RSEL-2006A | RSEL-2006WL |
| Rated Voltage (AC, DC) | V 250V | | | | | | | | | |
| Rated Current | 0.5A | | 1A | | 2A | | 3A | | 6A | |
| Withstand Voltage | V Terminals to Case: 2500VAC (1 Minute) | | | | | | | | | |
| Isolation Resistance | MΩ 100MΩ minimum (500VDC, 1 Minute) | | | | | | | | | |
| Leakage Current (max) | A RSEL-20xxx 1mA; RSEL20xxxL 10uA (250VAC, 60Hz) | | | | | | | | | |
| DC Resistance (total) | 700 | | 600 | | 250 | | 150 | | 80 | |
| Operating Temperature | °C -25 to +85°C (Derate above 55°C, see derating curve) | | | | | | | | | |
| Storage Temperature | °C -25 to +85°C | | | | | | | | | |
| Safety Agency Certifications | - UL1283, CSA C22.2 No.8, EN60939 | | | | | | | | | |
| Weight | g 61g Maximum | | | | | | | | | |
| Warranty | yr 1 Year | | | | | | | | | |

Options

| | |
|---|-------------|
| Wire Terminations | RSEL-20xxW |
| Lug Terminations | RSEL-20xxA |
| Wire Terminations & Low Leakage Current | RSEL-20xxWL |
| Lug Terminations & Low Leakage Current | RSEL-20xxAL |

Derating

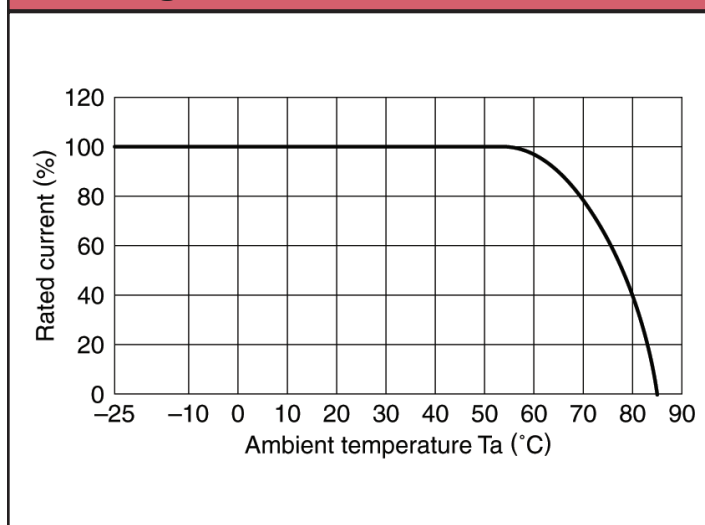

Outline Drawing

RSEL-20R5/2001/2002/2003/2006W(L)

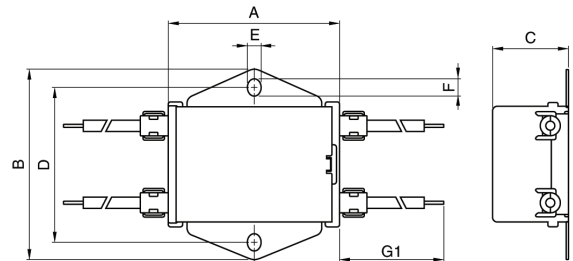

RSEL-20R5/2001/2002/2003/2006A(L)

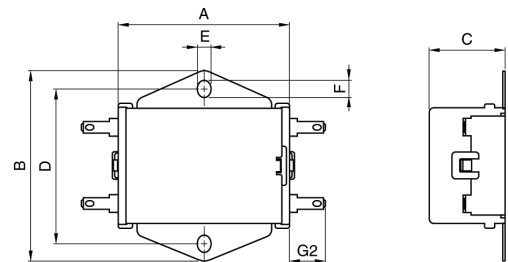

Circuit

RSEL-2 *** W
RSEL-2 *** A

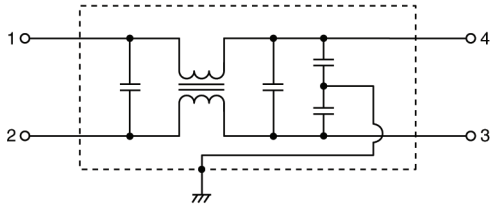

RSEL-2 *** WL
RSEL-2 *** AL

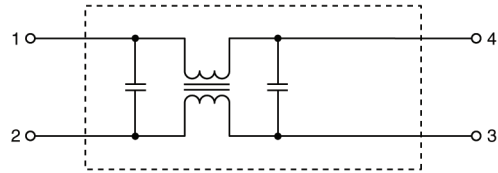

Attenuation Characteristics

RSEL-20R5W/A

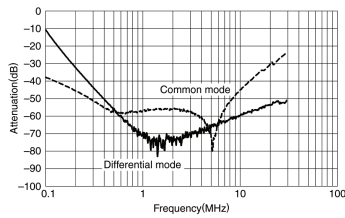

RSEL-2001W/A

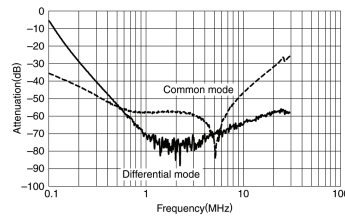

RSEL-2002W/A

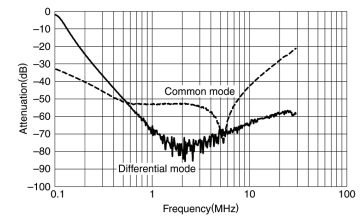

RSEL-2003W/A

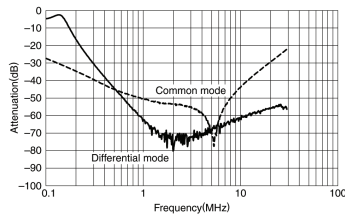

RSEL-2006W/A

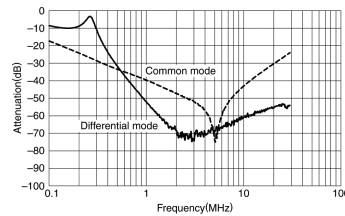

RSEL-20R5WL/AL

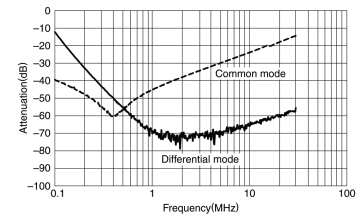

RSEL-2001WL/AL

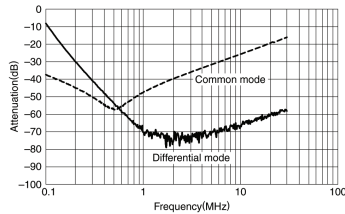

RSEL-2002WL/AL

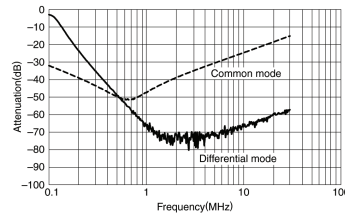

RSEL-2003WL/AL

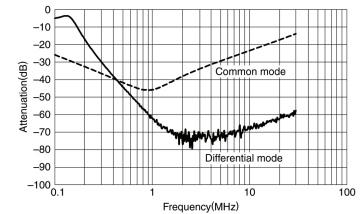

RSEL-2006WL/AL

